

Safe Fleet Duet™

Dual-Lens Camera and DH4C Recorder System

The Safe Fleet Duet features a 4-channel video recorder with solid-state storage, built-in GPS receiver, gravity sensor and an optional wi-fi antenna connector for video off-loading that is compatible with the Safe Fleet video management system. The standard Duet package includes a DVR and a 1080p AHD dual-lens camera leaving 2 spare video channels for other applications. The dual-lens cameras provide forward and inward-facing camera views to monitor traffic and other subjects such as driver, passenger and cargo.

The Safe Fleet Duet is a cost-effective event recording system that helps fleet managers identify risks to driver and passenger safety, coach better driver performance and reduce collision, insurance, and fleet operating costs.



Powerful Event Reconstruction

High-quality video and telematics data combine to provide multi-channel video and audio, vehicle speed and location, path travelled, and driver behavior data.

Built for Fleets

The Safe Fleet Duet was built for fleets with commercial-grade hardware, solid-state recording, intuitive video player and superior quality.

Small Footprint. Easy Install.

The windshield-mounted HD2D dual lens cameras are small enough to allow for a quick install discretely within the vehicle to prevent driver distraction or view obstruction.

Other Compatible Cameras:



HD2Q
Interior Dome



HD3Q
Interior Dome



HD3U
Interior Camera



HD3W
Outdoor Wedge

Accessories:



“RGY-Button” Event
Diagnostic Module



GPS Antenna



WiFi Antenna

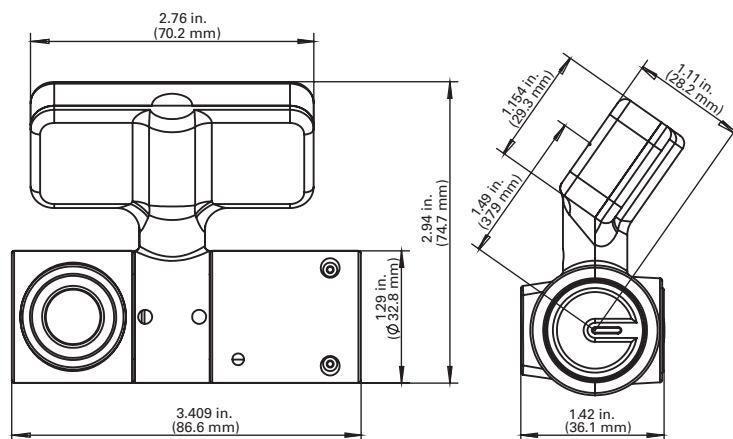

1.877.630.7366
safefleet.net

SAFE FLEET
Driving Safety Forward™

Safe Fleet Duet™

Dual-Lens Camera and DH4C Recorder System

In-Cab Coverage

Increased inward facing camera vertical FOV for in-cabin recording that covers operator from head to below waist line.

Full Location History

Built-in GPS displays path travelled and vehicle location on a map synchronized with camera views.

Safety Monitoring

Built-in G-force sensor records driving events such as harsh braking or high-speed turning.

High-Quality Cameras

1080p AHD Cameras with IR-equipped front camera and low-lux inward facing camera.

Solid State Recording

No moving parts with up to 466 hours of video/event data recording.

Video	
Recording Channels	4 channels video (HD or Std Res) and audio
Dual Stream Record Video Resolution	Main Stream: Configurable to 1080p on each channel with options 1920x1080 (1080p), 1280x720 (720p), and 720x480 (D1) Second Stream: Fixed at 320x240 (CIF) for all channels
Dual Stream Record Video Rate	Main Stream: 30 FPS on all video channels at 720p or less, 15 FPS on all video channels at 1080p Second Stream: 1-5 FPS independent of the main stream
Quality Settings	Adjustable, 4 levels
Codec	H.264
Auto Overwrite	Selectable On/Off
Display Modes	1UP or 4UP
Playback Rate	Frame advance, FFD and REV playback up to 32x
Search Function	Segment, alarm, date/time, event
User Interface	OSD with mouse, web browser, Evidence Manager video review software
Delay On/Off	Record Delay on ≤1 hr Record Delay off ≤1 hr Power Delay off ≤4 hr
On-Screen Display	Main title, time & date, record status
Dual Stream Transmission	Transmit main or second stream live video and audio over an optional broadband (cellular) network
Storage	
Primary	SD Card Options: 128GB, 256GB, 512GB, 1000GB (1TB)
Input/Output	
Interface Ports	1 Ethernet (12V PoE), 2 USB, 1 Video Out
Monitored Inputs	5 Signals + 1 Alarm (Event Button)
Status Indicators	3 LED on DVR + Optional Diagnostic Indicator
Wireless	
GPS	GPS Module Built-In with rear mounted SMA
Wi-Fi	802.11 Module Built-In (AC, AN, BGN) with rear mounted SMA
Smart Features	
Smart-Temp™	Ensures the DVR stays at its optimal operational temperature
Smart-Start™	Vehicle startup voltage protection safeguards DVR from electrical spikes
Smart-Stop™	Shuts down DVR if download activity is complete (requires Commander)
Temp Power	Turns on DVR for short duration maintenance activities
Inertia Sensor	3 axis G-sensor built-in
Electrical	
Voltage Range	9 to 32 VDC Operating
Transient Protection	600 W for power input, 400 W per signal input
Configuration Backup	Time & programmed info (retained up to 10 years)

Mechanical/General	
Dimensions (H x W x D)	1.6 x 6.2 x 6.9 in (41 x 157 x 174 mm)
DVR Weight	1.4 lbs (643 grams)
Primary Storage Lock	Restricts access to media removal
Environmental	
Operating temperature	-30 to 55°C (-22 to 131°F); fanless design
Approvals	
Emissions	FCC Part 15, Class A
Shock, Vibration, & Electrical	Tested against SAE-J1455 and MIL-STD-810G standards for Heavy Duty Vehicles
Dual-Lens Cameras	
Imaging Device	1/3" CMOS
Focal Lengths	HD2D0402AI: 3.6mm (front), 2.1mm (inward); HD2D0202AI: 2.1mm for both front and inward
FOVs	Forward-Facing: 2.1mm (H138°, V71°), 3.6mm (H90°, V49°) Inward-Facing: 2.1mm (H128°, V68°)
Signal System	PAL / NTSC
Resolution AHD	1080p (effective 1920 (H) x 1080(V))
Capable FPS	25 / 30
SNR	≥ 50dB
White Balance	Auto
Audio	Front camera only: 0.5V +/- 20%
Operating Voltage	12VDC
Operating Temperature	-20°C to 50°C
Housing	Metal aluminum alloy
Ingress Protection	IP54
Regulatory	FCC, PROP65, CE
Antivibration	Yes
Night Vision	Inward-facing camera only
Mounting	Wind-shield mounted via 3M tape
FPS	25 / 30 frames
Shutter	Electronic, automatic
Exposure Mode	Anti-exposure
Infrared Distance	0 - 3m
Connection	Single pigtail with dual 2x3 micro-fit connectors one for each camera module)
Ordering Information	
HD2D0202AI	Dual Lens Camera, 1080P AHD, 2.1mm Lens (Forward-Facing and Inward-Facing), Microphone
HD2D0402AI	Dual Lens Camera, 1080P AHD, 3.6mm Lens (Forward-Facing), 2.1mm Lens (Inward-Facing), Microphone

1349-SF-DUET-SS-ST-013023

Copyright ©2023 Safe Fleet and its subsidiaries. All rights reserved. No part of this publication may be reproduced by any means without written permission from Safe Fleet. The information in this publication is believed to be accurate. However, Safe Fleet does not make any representation or warranty to that effect and does not assume responsibility for any consequences resulting from use of such information. Revisions or new editions of the publication may be issued (or not issued) in our discretion to incorporate such changes. Information may change without notice.

1.877.630.7366
safefleet.net

SAFE  FLEET
Driving Safety Forward™