

# TRANSIT MIRRORS

## SHUTTLE MIRROR

### New Features

- Reduced vibration
- Inner & outer fender support = yields more stable mirror with less vibration
- Non-hood mount like typical "fender applications"
- Supplied drill fixtures for increased mounting consistency installation ease
- 10% reduced weight (compared to previous models)



### Glass Options

- Heated
- Remote
- In Glass Turn Signal
- Outside Turn Signal (OTS)

### Head Options

- 9" x 13"
- 8" x 15"
- 6" x 12"

**23%**  
VIBRATION REDUCTION!

U.S. Patent 9,180,816



# MOTORCOACH MIRRORS



## EXTERIOR & INTERIOR

### Head Size

- 9" x 13"

### Options

- Heated
- Remote
- In Glass Turn Signal
- Outside Turn Signal (OTS)

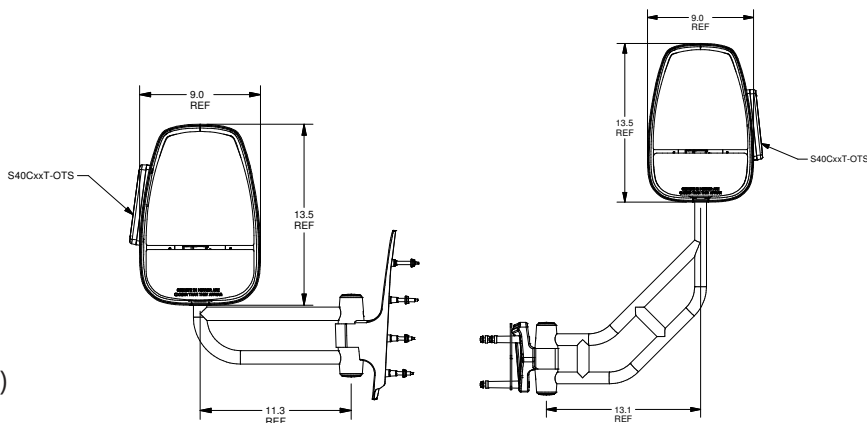

#### Roadside Mirror Ford E350/450

Mirror Model 9x13	Part #
MFMCX	S40C06T
HMFHMCX	S40C08T
RFMCX	S40C22T
HRFHMCX	S40C10T
RFRCX	S40C24T
HRFHRCX	S40C12T

#### Curbside Mirror Ford E350/450

Mirror Model 9x13	Part #
MFMCX	S40C07T
HMFHMCX	S40C09T
RFMCX	S40C23T
HRFHMCX	S40C11T
RFRCX	S40C25T
HRFHRCX	S40C13T

### Head Size

- 8" x 15"

### Options

- Heated
- Remote
- In Glass Turn Signal
- Outside Turn Signal (OTS)

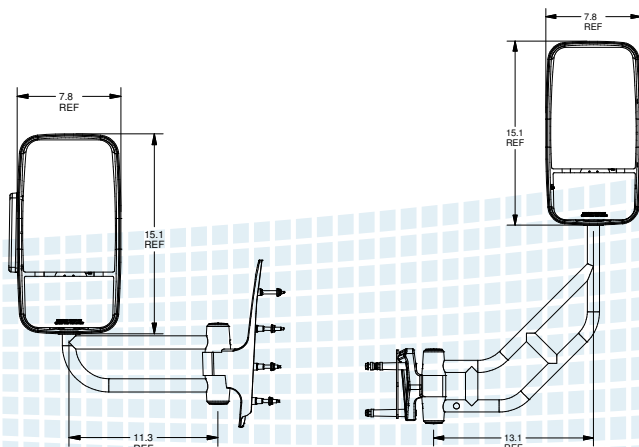

#### Roadside Mirror Ford E350/450

Mirror Model 9x13	Part #
MFMCX	S40C06T
HMFHMCX	S40C08T
RFMCX	S40C22T
HRFHMCX	S40C10T
RFRCX	S40C24T
HRFHRCX	S40C12T

#### Curbside Mirror Ford E350/450

Mirror Model 9x13	Part #
MFMCX	S40C07T
HMFHMCX	S40C09T
RFMCX	S40C23T
HRFHMCX	S40C11T
RFRCX	S40C25T
HRFHRCX	S40C13T

### Head Size

- 6" x 12"

### Options

- Heated
- Remote
- In Glass Turn Signal
- Outside Turn Signal (OTS)

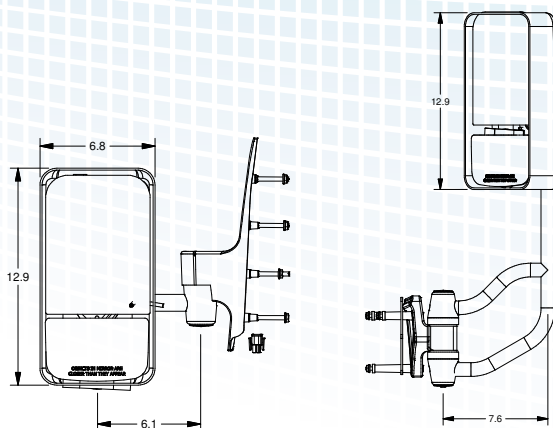

#### Roadside Mirror 6x12 Ford E350/450

Mirror Model 6x12	Part #
MFMCX	S40L06A
HMFHMCX	S40L08A
RFMCX	S40L22A
HRFHMCX	S40L10A
RFRCX	S40L24A
HRFHRCX	S40L12A

#### Curbside Mirror 6x12 Ford E350/450

Mirror Model 6x12	Part #
MFMCX	S40L07A
HMFHMCX	S40L09A
RFMCX	S40L23A
HRFHMCX	S40L11A
RFRCX	S40L25A
HRFHRCX	S40L13A